



**GLENDALE
COMMUNITY
COLLEGE**
6000 W. Olive Ave.
Glendale, Az 85302

**Telephone
Registration**
623.845.3300

**Línia telefónica
para información**
623.845.3315

**Materials
Request Line**
623.845.3314

**Admissions &
Records**
623.845.3300

Main Switchboard
623.845.300

Parking Tips

Traffic congestion is high during:

7:30 a.m. to 1:30 p.m.
and
5:00 p.m. to 7:50 p.m.

To find a parking space, easily arrive early.

Keep in mind:

- 65% of parking spaces are located north of campus
- Parking spaces are usually available in lot S5, most easily accessible via 63rd Ave.
- Allow 30 minutes before class starts for parking and walking to class
- **DO NOT** park in grassy areas.
- **DO NOT** park in disabled or employee parking spaces without appropriate decal.

(S) - Student Parking Lot #

(E) - Employee

(V) - Visitor

(M) - Motorcycle

(♿) - Disabled

(♿) - Wheelchair

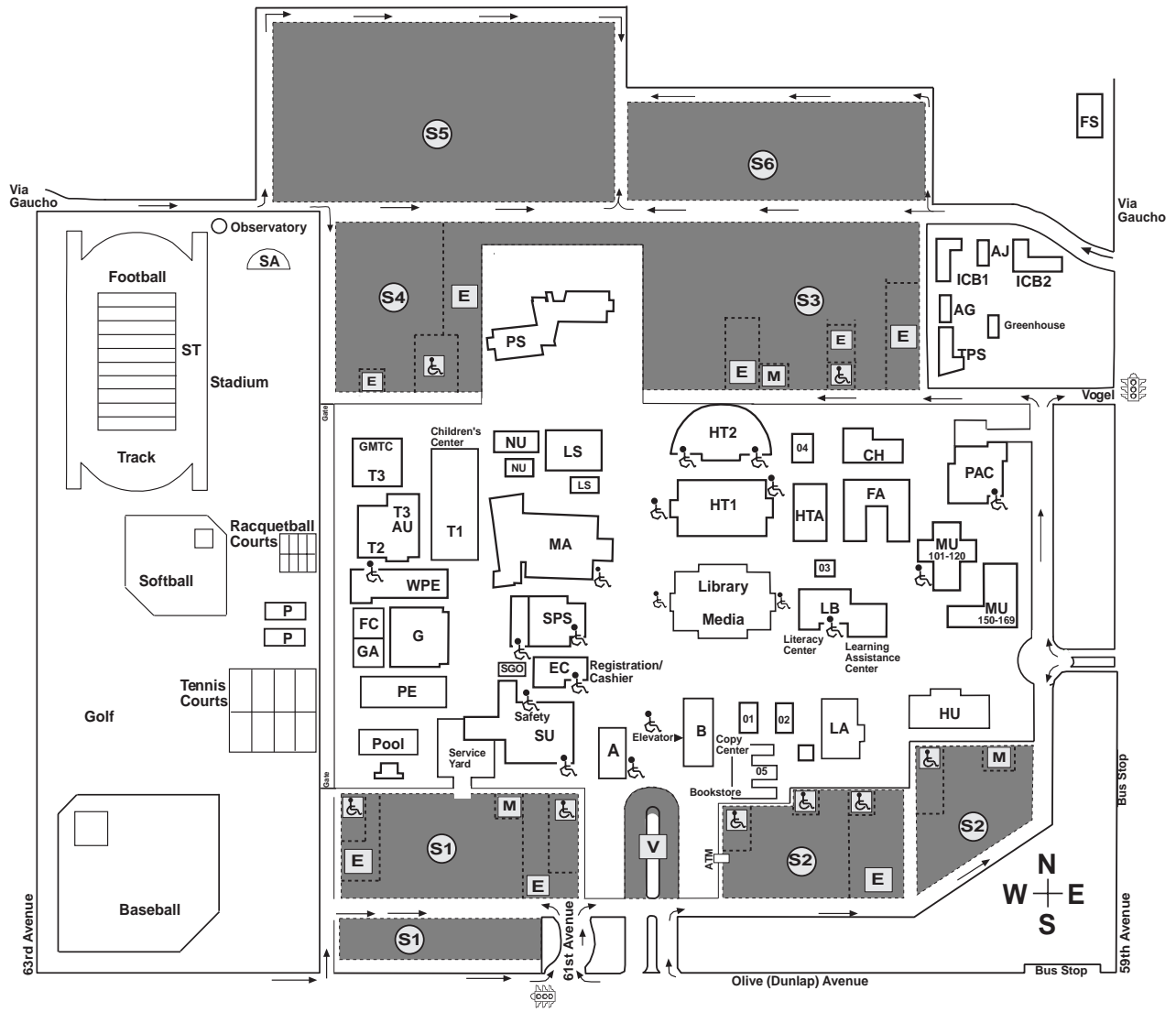

Building Key

| | | |
|----------------------------------|--------------------------------------|---|
| 01 Faculty Offices 01-101 to 131 | HT1 High Tech Center 1 | SPS Student Personnel Services |
| 02 Faculty Offices 02-101 to 133 | HT2 High Tech Center 2 | ■ Admissions and Records |
| 03 Faculty Offices 03-101 to 133 | HU Humanities | ■ Assessment |
| 04 Faculty Offices 04-101 to 126 | ICB 1 Institute Classroom Building 1 | ■ Career Center |
| 05 ■ Bookstore | ICB 2 Institute Classroom Building 2 | ■ Special Interest |
| ■ Copy Center | L Library | ■ Counseling |
| ■ Faculty Offices 05-101 to 152 | ■ Media Center | ■ Disability Services and Resources |
| A Administration | LA Language Arts | ■ Financial Aid |
| AG Agriculture | LB Liberal Arts | ■ Job Placement |
| AJ Administration of Justice | ■ ACE + | ■ Veterans Services |
| B Business | ■ Learning Assistance Center | ST Stadium |
| ■ International Students Center | ■ Literacy Center | SU Student Union |
| CH Choice Hotels Call Center | LS Life Sciences | ■ College Safety |
| EC Enrollment Center | ■ Psychology | ■ Council Chambers |
| ■ Advisement | MA Math | ■ Palms Café |
| ■ Cashier | MU Music | ■ Student Life |
| ■ Multi-Cultural Affairs | ■ Rooms 101-120 | ■ Student Lounge |
| ■ Registration | ■ Rooms 150-169 | T1 Technology 1 |
| ■ University Transfer Center | NU Nursing | ■ Children's Center |
| FA Fine Arts | P Portable Classrooms | T2 Technology 2 |
| FC Fitness Center | PAC Performing Arts Center | ■ Institute for Business, Industry and Technology |
| FS Fire Station | PE Physical Education | T3 Automotives |
| G Gym | ■ Locker Rooms | TPS Technology Public Services |
| GA Gym Annex | PS Physical Science | WPE Women's Physical Education |
| ■ Fitness Center | SA Soleri Amphitheatre | |
| HTA High Tech Annex | SGO Student Government Offices | |